



Buddi Alcohol Monitoring Solution

Empowering Sober Futures

Alcohol and Location Monitoring in One Device

Buddi's new Alcohol and Location Monitoring solution provides a unified tool for managing both alcohol and/or high-risk caseloads that ensures real-time understanding of consumption and GPS tracking events for optimal public safety and wearer accountability.

- + Real-time alcohol monitoring with "hot" consumption alerts
- + Full featured GPS standard tracking
- + Unified software environment to manage sobriety and safety behaviors
- + Precise and configurable alcohol threshold triggers
- + Discreet, rechargeable

//
Accurate
and Reliable

Why Buddi?

Buddi's new and combined Realtime alcohol and location tracking provides instant access to a wearer's sobriety and travel patterns in one unique 24/7 solution platform.



Comprehensive Sobriety and Abstinence Program Tool

- 24/7 sobriety tracking for critical supervision term(s) compliance
- Can flexibly support each agency's caseloads across: EBP programs, 24/7 Sobriety, DUI/DWI Courts, Probation, Parole, Pretrial, etc..
- Leverage as a verification tool for abstinence phases or other alcohol/location specific programs



Simplified Agency Administration

- Realtime alcohol or zone alerts ensure agency's can employ swift and certain best practice responses
- Unified software tracks important alcohol events with location data
- Single device for both alcohol and location
- Industry's easiest to install strap works



Wearer Sobriety Accountability

- Discreet yet physical accountability reminder
- Data is transmitted in realtime without office visit (minimizes lifestyle disruptions and stabilization efforts)
- 24/7 Monitoring Can Help Combat Wearer's "Circumvention" mindset

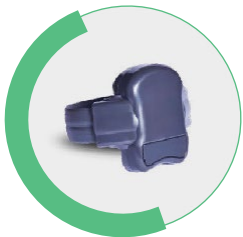

Buddi Alco Tag

- Combined alcohol and GPS tracking
- 24/7, Transdermal, Rechargeable Lightweight Device
- Sobriety and Location Data Viewable in Realtime
- Industry's fastest strap installation and removal



Alcohol Testing

- Consumption and Confirmation natively available in Eagle platform
- Wireless alcohol/temperature data upload
- Proprietary design for managing true drinking events vs. environmental
- Testing thresholds' configurable by agency
- "Hot" test can be co-located with GPS mapping information



Critical Alerts

- Instant reliable alerts when alcohol is detected
- Alcohol events verified without additional human verification
- Alcohol or Location Alerts Can Be Created to Support Wearer's supervision requirements as well as treatment schedule



Software/System

- Unified platform for viewing both location and alcohol data
- Configurable to adapt to Agency's unique caseloads and programs
- Robust reporting available to provide leadership with actionable agency performance metrics (track events, violations, etc..)
- System security